

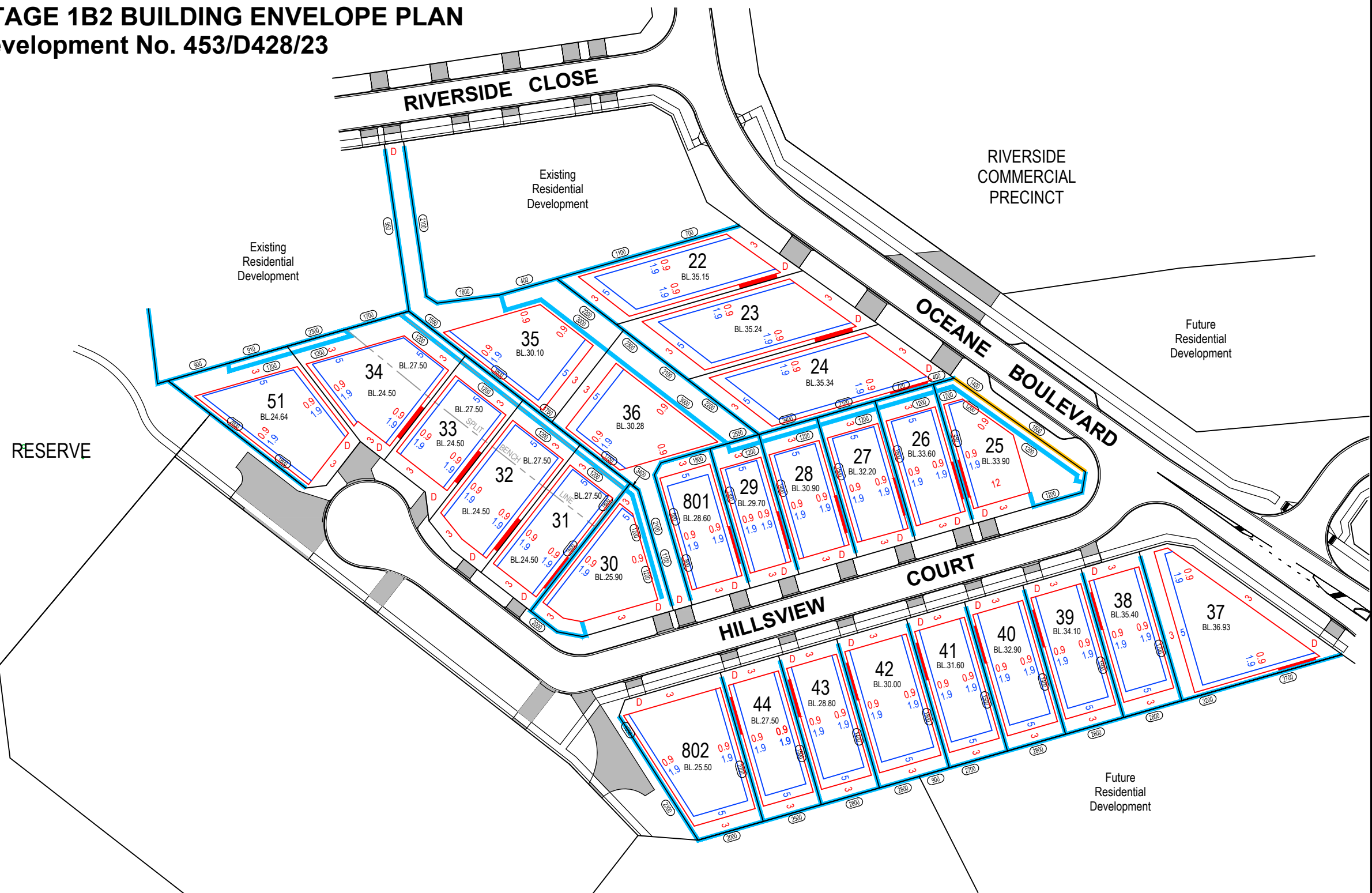









07.02.2025

OCEANE - STAGE 1B2 BUILDING ENVELOPE PLAN

Development No. 453/D428/23



-  Denotes garage can be built on boundary. If not on boundary 900mm minimum setback applies.
-  Easement
-  Denotes single storey setback to boundary or rear retaining wall. (Note: Front setback measured to front facade - excluding verandah or portico)
-  Denotes second storey setback to boundary (or if side wall greater than 3m high).
-  Denotes driveway location.
-  Denotes retaining wall by Developer.
-  Denotes fence and retaining wall by developer
-  Denotes bench level.
-  Denotes retaining wall height in mm.

Minimum front setback to garage 5.5 metres.

Envelopes show the minimum setback requirements and driveway locations only. Council and Planning and design Code requirements must also be adhered to with respect to private open space and other considerations.

Retaining wall information and bench levels derived from TMK dwg no. 2404179-C03/B

Road names are subject to approval by the City of Victor Harbor.

